

轻型卧式多级离心泵

Light horizontal multistage centrifugal pump



CMH8

性能曲线 Performance curves

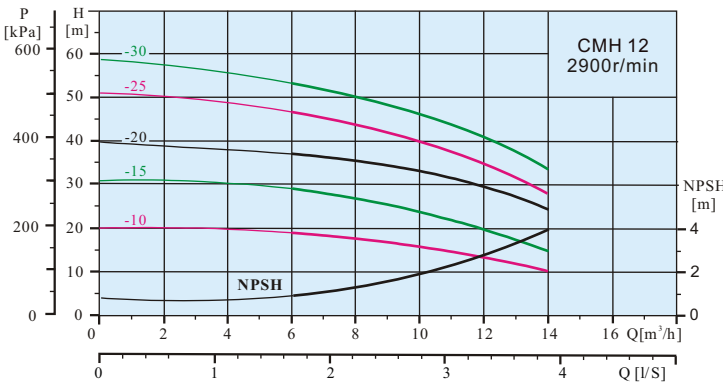
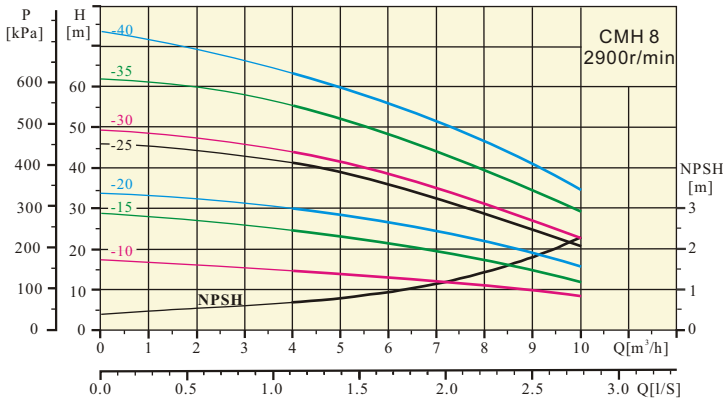

安装结构图 Installation Structure

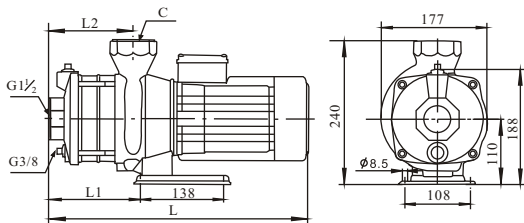

泵型号 MODEL	配套 功率 P ₂ (kW)	尺寸/Size(mm)								重量 Weight (kg)
		单相 Single-phase				三相 three-phase				
		L	II	L2	C (in)	L	II	L2	C (in)	
CMH8-10(T)	0.55	325	69	78	G1 1/2	325	69	78	G1 1/2	13
CMH8-15(T)	0.75	355	99	108	G1 1/2	355	99	108	G1 1/2	15
CMH8-20(T)	1.0	355	99	108	G1 1/2	355	99	108	G1 1/2	18
CMH8-25(T)	1.50	420	129	138	G1 1/2	420	129	138	G1 1/2	20
CMH8-30(T)	1.85	420	129	138	G1 1/2	420	129	138	G1 1/2	25
CMH8-35(T)	2.20	510	159	168	G1 1/2	450	159	168	G1 1/2	30
CMH8-40(T)	2.20	510	159	168	G1 1/2	450	159	168	G1 1/2	31
CMH12-10(T)	1.0	325	69	78	G1 1/2	325	69	78	G1 1/2	15
CMH12-15(T)	1.50	390	99	108	G1 1/2	390	99	108	G1 1/2	18
CMH12-20(T)	1.85	450	99	108	G1 1/2	390	99	108	G1 1/2	20
CMH12-25(T)	2.20	480	129	138	G1 1/2	420	129	138	G1 1/2	24
CMH12-30T	3.0					480	129	138	G1 1/2	27

220V/60Hz, 110V/60Hz models are available on request

电机

2极异步电动机；
三相：380~415V / 50Hz
单相：220~240V / 50Hz
单相电机安装热保护器；
绝缘等级：B级或F级
防护等级：IPX5
工作方式：连续

Motor

2-pole induction motor;
three-phase: 380~415V/50Hz
Single-phase: 220~240V/50Hz
Single-phase with thermal protector
Insulation class: B or F
Protection: IPX5
Continuous duty

适用范围

CMH系列为小型卧式多级离心泵，在家庭供水、工业、建筑等方面有广泛用途。可用于：

- 空调系统
- 冷却系统
- 消防系统
- 工业清洗、液体输送及循环
- 水处理(水的净化)
- 家庭供水、花园喷灌、
- 增压、环境应用
- 其它许多特定用途。

Application:

CMH series are mini horizontal centrifugal pump, have a wide application in domestic water supply, industry and constructions. They are used for:

- Air-conditioning system
- Cooling system
- Fire fighting system
- Industrial cleaning, conveyance and circulation of liquid.
- Water treatment (Water purification)
- Domestic water supply, garden sprinkler
- Boosting, environment
- Many other special application.

运行条件

稀薄、干净、非易燃易爆并且不含固体颗粒或纤维的液体；

液体温度：常温型 -20℃至70℃
热水型小于105℃

最高环境温度：+50℃

最大运行压力：10 bar

最大进口压力受最大运行压力限制

Working conditions:

Thin, clean, non-flammable and non-explosive liquid containing no solid granules and fibers;

Liquid temperature: Standard Model: -20℃~70℃, Hotwater less than 105℃;

Max. environmental temperature: +50℃

Max. operating pressure: 10 bar

Max. suction pressure is limited by max. Operation pressure.